

Index	Date	Description	Signature	Signature	Signature
E					
D					
C					
B					
A					

			MINISTERUL TRANSPORTURILOR
			BENEFICIAR / BENEFICIARY : COMPANIA NATIONALA DE CAI FERATE "CFR" SA

PROIECTANT / DESIGNER: 		Data / Date 01.2013	Semnatura
Aprobat Approved	Sef de echipa Team leader	C. Teodorescu	
Verificat Checked	Expert Cheie Key Expert	R. Trommer	
Subcontractant / Subcontractor 			
Aprobat Approved	Adjuncti Sef de echipa Deputy Team leader	A.M. Baicu	
Proiectat Designed	Inginer Engineer	A. Sopov	

"Reabilitarea liniei c.f. Frontieră - Curtici - Simeria, parte componentă a coridorului IV Pan - European pentru circulația trenurilor cu viteză maximă de 160 km/h" Tronsoanel 2-B : cap Y Bărzava - cap Y Iliu	Project 9/ 35311.1
"Rehabilitation of the Railway Line Border - Curtici - Simeria, component Part of the IV Pan - European Corridor for the Trains Circulation with maximum speed of 160 km/h" Section 2-B : end Y Bărzava - end Y Iliu	Faza / Phase: PTh +CS / TD + TS

Denumire desen / Drawing Title :
 Plan de situatie cablu FO subteran pentru semnalizare - Statia VARADIA /
 VARADIA Station - Layout plan underground cable with OF for signalling
 Km 546+900 - Km 547+800

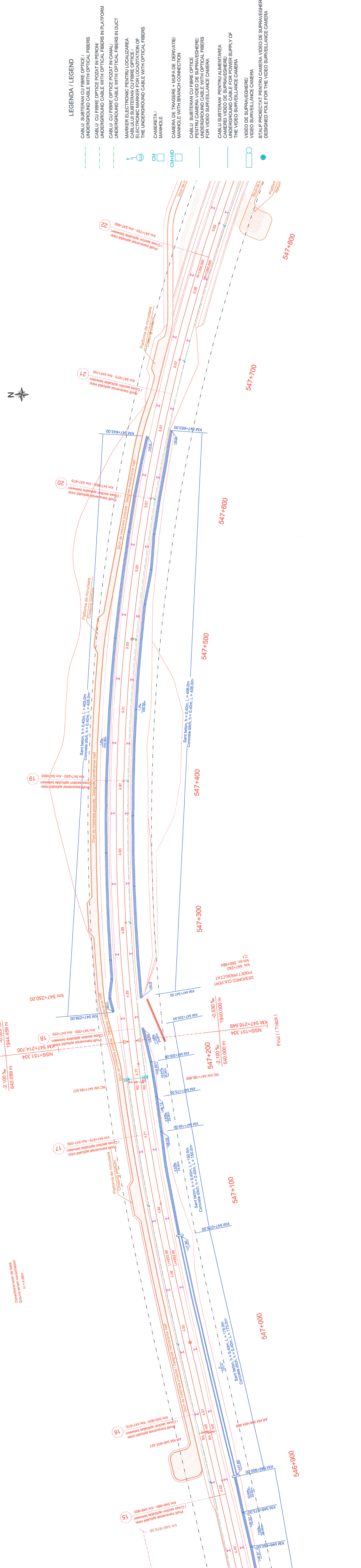

Scara / Scale 1:1000	Revizia / Revision 1/16.05.2013	Cod desen / Drawing Code PT.02.05.12.SM.028	Nr / No 02/10
--------------------------------	---	---	-------------------------